

Wall Lining System





Wall Lining System

Wall Lining systems are systems used to line brick, block and concrete walls with a basic aim to line the background or to improve the thermal or acoustic insulation. It is suitable for all internal applications. We have two types of wall lining systems:

- a) GyPLYNER™ metal frame wall lining system is a cost effective, virtually independent metal frame dry internal lining system. It is based on a lightweight metal frame clad with Gypboard® or Gyproc® plasterboards.
- b) DriLYNER™ system uses the principle of gypsum bonding plaster to bond Gypboard® or Gyproc® plasterboards directly to the wall.

Ease of handling and simple construction techniques make both GyPLYNER™ & DriLYNER™ one the quickest and most easily assembled systems currently available in the world.

Wall Lining System Range

DriLyner™: Featuring Gypboard® / Gyproc® plasterboard + Bonding plaster

- System consists of vertical dabs of bonding plaster used to secure plasterboard to the existing wall structure
- Fast & easy to construct
- Achieves U Values down to 0.28
- Smooth flush seamless surface on finish
- Helps correct background irregularities

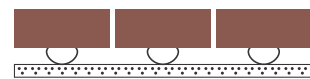
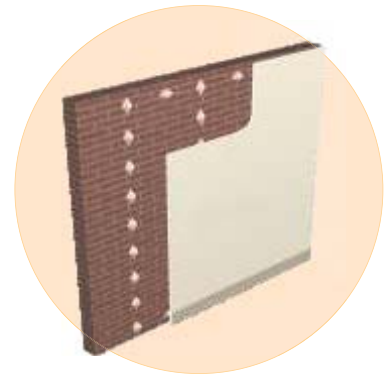

GyLyner™: Featuring Gypboard® / Gyproc® plasterboard + GyLyner™ sections

- System consists of fixing plasterboard to highly galvanized GyLyner™ section, secured to walls by fixing brackets
- Highly galvanized metal sections make it resistant to moisture, so it is not affected by damp and humid areas
- Saves space
- Easy passage of services
- Can satisfy thermal performance and acoustic requirements
- Smooth flush seamless surface on finish
- Helps correct background irregularities
- Suitable for new construction as well as refurbishment, old structures etc

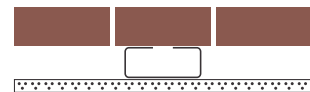
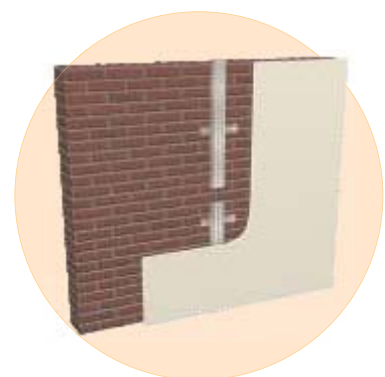

Installation overview

DriLyner (Back Bond) Wall Lining

Step I



Bare Wall

Step II



Vertical dabs of bonding plaster applied to wall

Step III



Dabs of bonding plaster are shown ready to take on the 2nd Plasterboard of the wall. This process will continue till the full wall is covered

Step IV



Final finishing is being done on tapered edge/square edge joint

Step V



Plasterboard fixing complete with jointing and finishing, ready for final surface finishing

GyLyner Wall Lining

Step I



Bare Wall

Step II



Framework made by using GyLyner™ channel section, vertically 610mm c/c and wall angle at floor & ceiling. Also showing fixing brackets used at mid-height.

Step III



Plasterboard being fixed to the framework with drywall screws

Step IV



Final finishing is done on tapered edge/square edge joint

Step V



Plasterboard fixing complete with jointing and finishing, ready for final surface finishing